

Y=2,609,250 +
 Y=2,608,750 +
 Y=2,608,750 +
 Y=2,608,500 +
 Y=2,608,250 +
 Y=2,608,000 +
 Y=2,607,750 +
 Y=2,607,500 +
 X=650,000
 X=650,250
 X=650,500
 X=650,750
 X=651,000

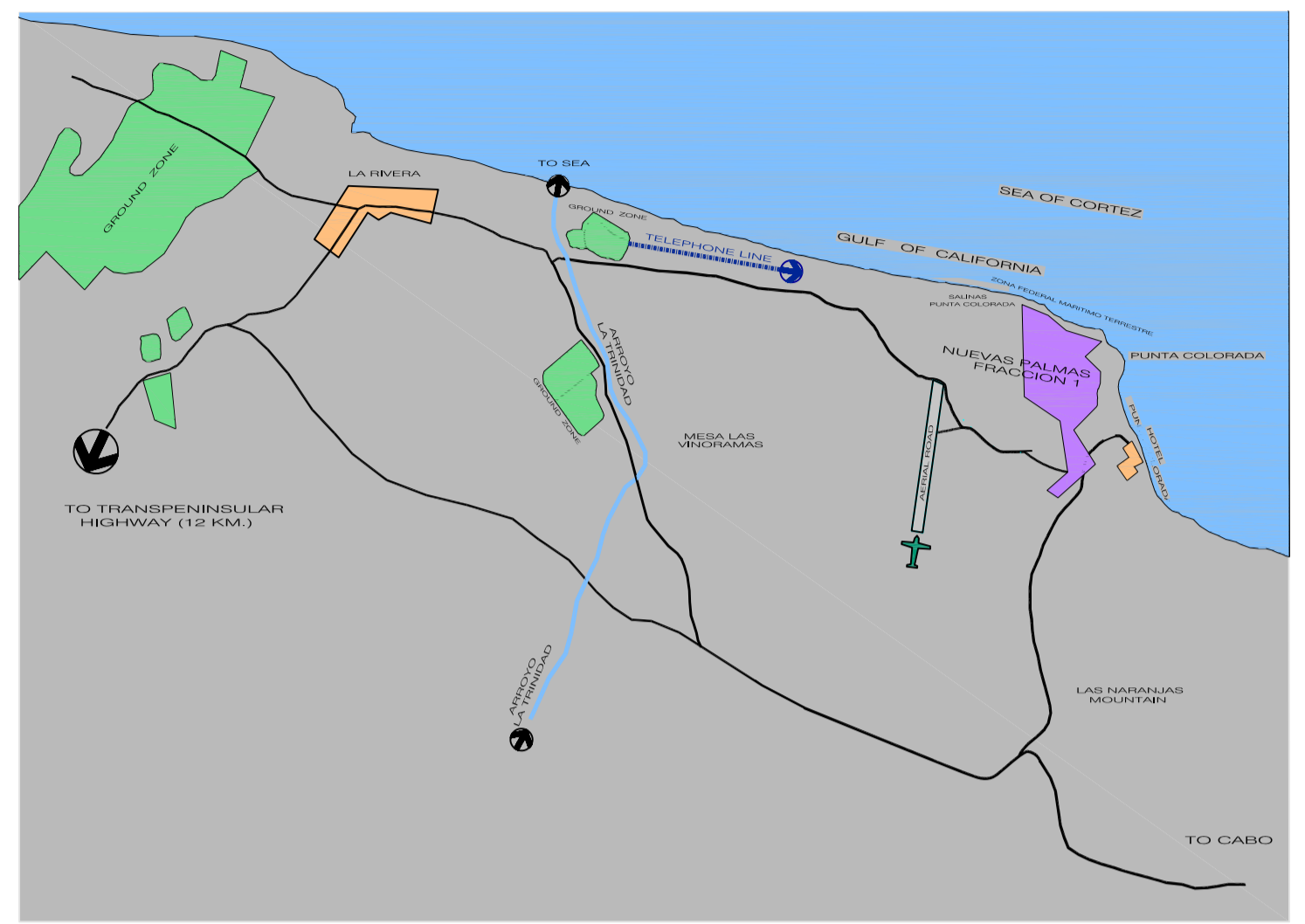
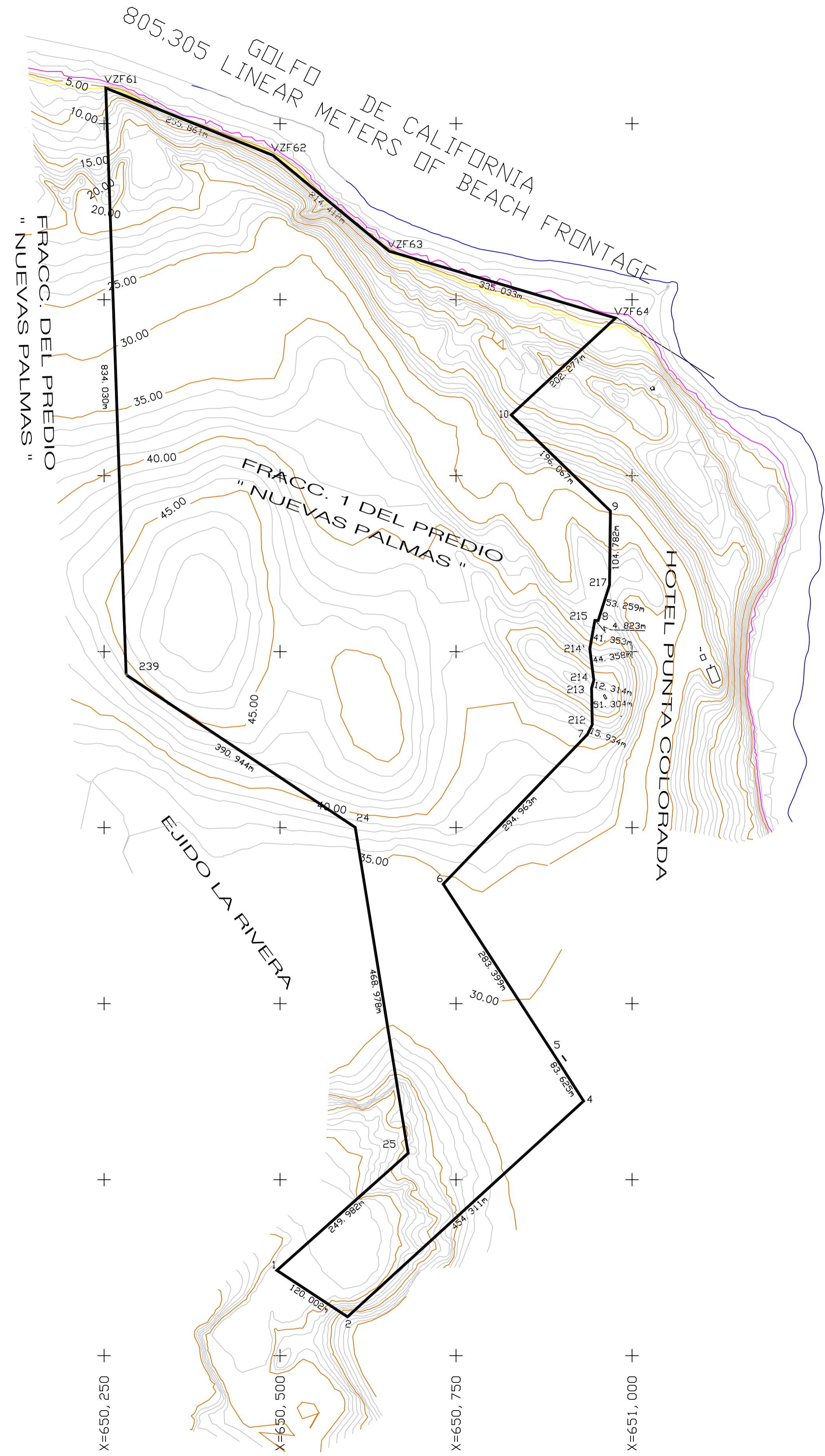

MACROLOCALIZACION

SIMBOLOGIA

VERTICE DE POLIGONO	○ 3
LIMITE DEL POLIGONO	— · — · —
COLINDANTE	ZONA FEDERAL



AREA

AREA 65-73-36.061 HAS

PLANO :

POLIGONO DE UNA FRACCION DEL PREDIO "NUEVAS PALMAS"

LOCALIDAD: LA RIVERA
 MUNICIPIO: LOS CABOS
 ESTADO: BAJA CALIFORNIA SUR
 PROPIETARIO: NUEVAS PALMAS CABO DEL ESTE

FECHA: JUNIO 2009
 ESCALA: 1:4 000
 ACOTACION: METROS

PLANO **TP_02**

ING. ANTONIO MORALES ZOQUIAPA
 CED. 2369830

CUADRO DE CONSTRUCCION FRACCION 1

LADO	EST	PV	RUMBO	DISTANCIA	V	COORDENADAS	Y	X
					VZF61	2,609,300.5691	650,252.3860	
VZF61	VZF62		S 68°04'58.03" E	255.861	VZF62	2,609,205.0649	650,489.7540	
VZF62	VZF63		S 50°30'00.34" E	214.412	VZF63	2,609,068.6826	650,655.1996	
VZF63	vzf64		S 73°33'07.24" E	335.033	vzf64	2,608,973.8197	650,976.5219	
vzf64	10		S 47°06'46.56" W	202.277	10	2,608,836.1588	650,828.3140	
10	9		S 45°57'19.85" E	196.067	9	2,608,699.8500	650,969.2468	
9	217		S 00°36'54.01" W	104.782	217	2,608,595.0739	650,968.1221	
217	8		S 17°36'58.39" W	53.259	8	2,608,544.3121	650,952.0037	
8	215		N 89°06'28.81" W	4.823	215	2,608,544.3872	650,947.1816	
215	214'		S 09°55'07.80" W	41.353	214'	2,608,503.6527	650,940.0585	
214'	214		S 07°20'15.87" E	44.358	214	2,608,459.6584	650,945.7238	
214	213		S 15°06'54.38" W	12.314	213	2,608,447.7700	650,942.5127	
213	212		S 01°13'58.12" E	51.304	212	2,608,396.4781	650,943.6165	
212	7		S 26°32'34.42" W	15.934	7	2,608,382.2238	650,936.4963	
7	6		S 43°56'08.95" W	294.963	6	2,608,169.8161	650,731.8358	
6	5		S 33°00'00.17" E	283.399	5	2,607,932.1379	650,886.1861	
5	4		S 32°34'11.68" E	83.625	4	2,607,861.6640	650,931.2039	
4	2		S 47°34'42.66" W	454.311	2	2,607,555.1952	650,595.8304	
2	1		N 56°43'23.73" W	120.002	1	2,607,621.0383	650,495.5051	
1	25		N 48°15'08.06" E	249.982	25	2,607,787.4892	650,682.0122	
25	24		N 09°13'44.44" W	468.978	24	2,608,250.3962	650,606.7971	
24	239		N 56°20'49.16" W	390.944	239	2,608,467.0427	650,281.3715	
239	VZF61		N 01°59'29.87" W	834.030	VZF61	2,609,300.5691	650,252.3860	

SUPERFICIE = 65-73-36.061 HAS